

1. Overview Plan and Bus Swept Path Analysis

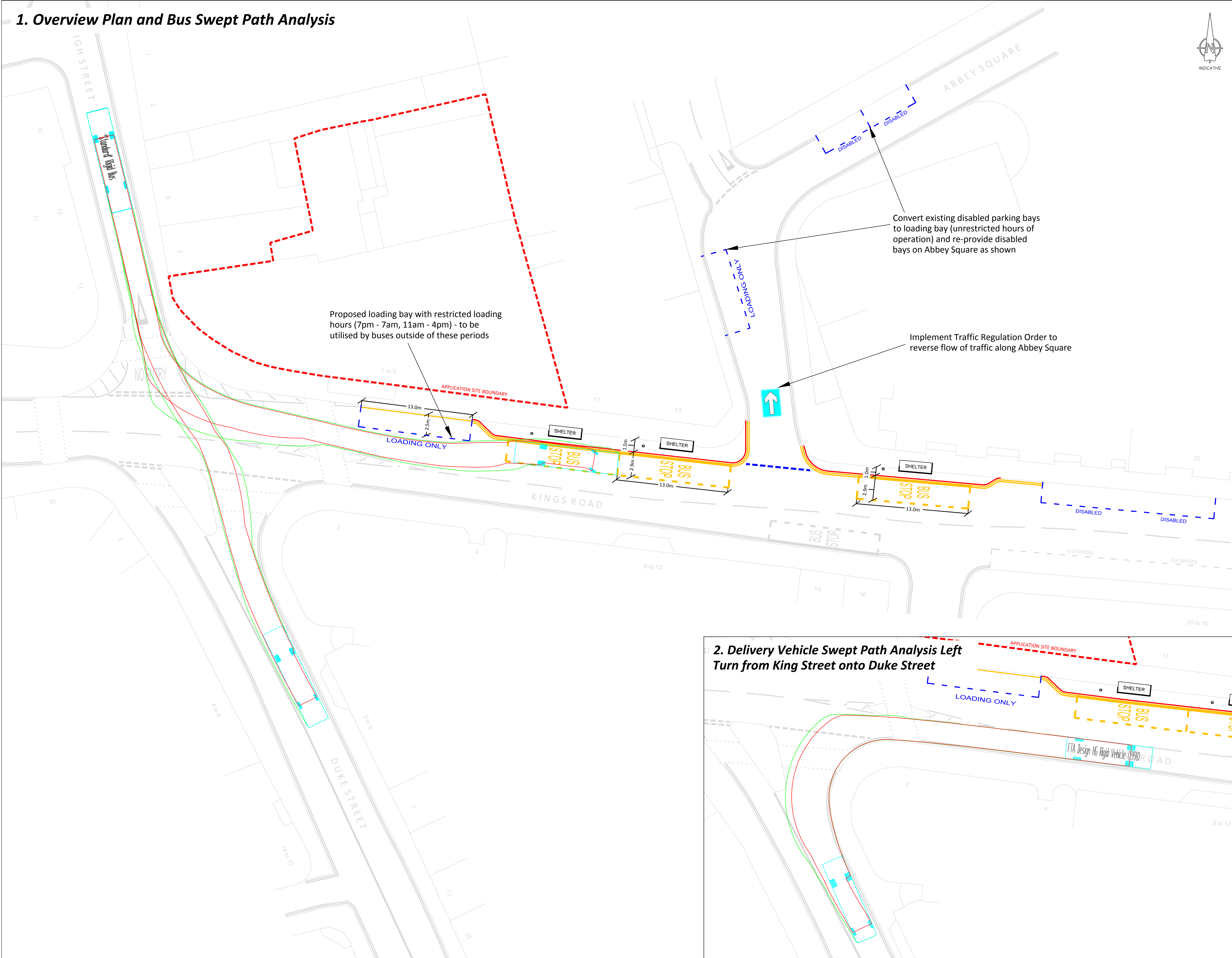

2. Delivery Vehicle Swept Path Analysis Left Turn from King Street onto Duke Street

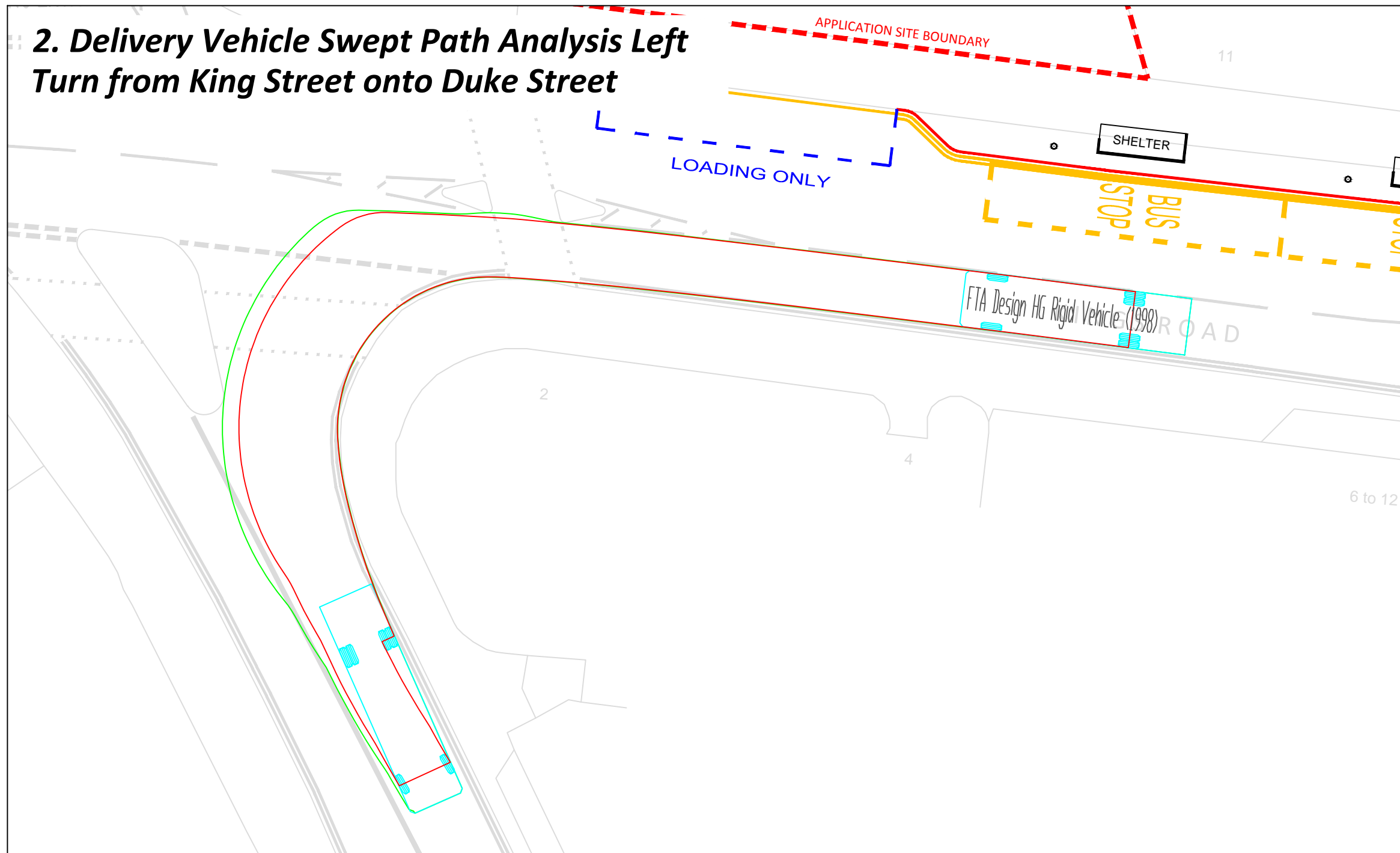

- Key
- Existing carriageway alignment / markings to be retained
 - Proposed kerbworks
 - Proposed carriageway markings
 - Proposed waiting restrictions
 - Replacement bus passenger infrastructure

Autotrack Vehicle Profiles:

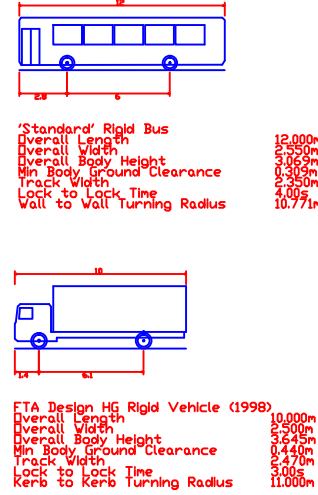

Drawing Revisions

Rev	Date	Details

Client
CAPITA HALL LTD.

Project
JACKSONS CORNER, READING

Title
RE-ORGANISATION OF BUS STOP
ARRANGEMENT AND LOADING
BAY FACILITIES ON KINGS
ROAD AND ABBEY SQUARE

MILESTONE
TRANSPORT PLANNING
Heritage House, 7 Wey Court, Mary Road
Guildford, Surrey, GU1 4QU
Tel: 01483 397888
web: www.milestonetp.co.uk

Status DRAFT	Scale 1:200@A1
Drawn TG	Checked MS
Drawing Number 060/SK03	Date June 14
	Revision